



LOTUS CRUISES

MEKONG NAVIGATOR



**MEKONG NAVIGATOR RIVER CRUISE
FOR PLATEAU INTERNATIONAL**

Date: 31 March 2022

**1. Mekong Navigator FIT Fare Summary in USD - 8 Days 7 Nights Cruises
Ho Chi Minh City – Siem Reap or vice versa**

	8 Days 7 Nights	
	Peak	Shoulder
	01 Oct - 31 Mar	01 Apr - 30 Sep
	USD	USD
01 Oct 2022 - 30 Sept 2023 Departures		
Superior Suite	2,871	2,189
Vista Suite	3,275	2,492
Signature Suite	3,679	2,795
Prestige Suite	4,285	3,250
Grande Suite	5,093	3,856
01 Oct 2023 – 30 Sept 2024 Departures		
Superior Suite	3,157	2,405
Vista Suite	3,602	2,739
Signature Suite	4,047	3,073
Prestige Suite	4,716	3,574
Grande Suite	5,606	4,243

**Sailing Dates – Mekong Navigator – 8 Days 7 Nights Cruises
Ho Chi Minh City – Siem Reap or vice versa**

Cruise Code	Direction	Program	Embarkation	Disembarkation
2022				
MN221016	UPSTREAM	7 nights	16 October, 2022	23 October, 2022
MN221127	UPSTREAM	7 nights	27 November, 2022	04 December, 2022
MN221225	UPSTREAM	7 nights	25 December, 2022	01 January, 2023
2023				
MN230115	DOWNSTREAM	7 nights	15 January, 2023	22 January, 2023
MN230212	DOWNSTREAM	7 nights	12 February, 2023	19 February, 2023
MN230219	UPSTREAM	7 nights	19 February, 2023	26 February, 2023
MN230319	UPSTREAM	7 nights	19 March, 2023	26 March, 2023
MN230326	DOWNSTREAM	7 nights	26 March, 2023	02 April, 2023
MN230416	UPSTREAM	7 nights	16 April, 2023	23 April, 2023
MN230423	DOWNSTREAM	7 nights	23 April, 2023	30 April, 2023
MN230917	UPSTREAM	7 nights	17 September, 2023	24 September, 2023
MN230924	DOWNSTREAM	7 nights	24 September, 2023	01 October, 2023
MN231001	UPSTREAM	7 nights	01 October, 2023	08 October, 2023
MN231008	DOWNSTREAM	7 nights	08 October, 2023	15 October, 2023

MN231015	UPSTREAM	7 nights	15 October, 2023	22 October, 2023
MN231126	UPSTREAM	7 nights	26 November, 2023	03 December, 2023
MN231203	DOWNSTREAM	7 nights	03 December, 2023	10 December, 2023
MN231210	UPSTREAM	7 nights	10 December, 2023	17 December, 2023
MN231217	DOWNSTREAM	7 nights	17 December, 2023	24 December, 2023
MN231224	UPSTREAM	7 nights	24 December, 2023	31 December, 2023
2024				
MN240107	UPSTREAM	7 nights	07 January, 2024	14 January, 2024
MN240211	DOWNSTREAM	7 nights	11 February, 2024	18 February, 2024
MN240303	UPSTREAM	7 nights	03 March, 2024	10 March, 2024
MN240407	DOWNSTREAM	7 nights	07 April, 2024	14 April, 2024

Rate condition:

- Prices are in USD per person
- Prices are based on Double Occupancy

Single Accommodation:

- 30% surcharge of Double Occupancy

Included:

- 7 nights onboard the luxurious Mekong Navigator
- Full board including themed dinners, welcome and farewell reception.
- Complimentary house wine for dinner.
- Complimentary local coffee and fine tea selection, soft-drinks, local beer and local spirits
- Complimentary water bottle for excursions
- Complimentary wifi in-room and public areas
- Lotus Cruises exclusive's series of cultural performances, educational talks, food demonstration classes
- English speaking crew and English expert local guides
- All entrance fees, transportation as mentioned in the shore excursion program
- Deluxe Sampans with cold towel service, fresh fruit and tea/coffee service (where applicable)
- Individual VOX listening devices throughout cruise shore excursion program
- Shoe cleaning after excursion
- Welcome drink and cold towel service following excursions
- Transfers from Siem Reap to Kampong Cham and from My Tho to Ho Chi Minh City (Coach transfers)
- Gratuities \$85 per passenger

Not Included:

- Port Charge \$75 per passenger
- Visa. For Upstream cruises only: Cambodia E-Visa will not be accepted at river check point, we recommend to make visa on arrival when you are on the cruise with us, visa cost 40 USD/person)
- Airfare to/from destination
- Premium wine and spirits
- Transfer outside included transportation as provided in the shore excursion program
- Spa treatments, on-board laundry and gift shop items

2. Mekong Navigator FIT Fare Summary in USD - 5 Days 4 Nights Cruises
Ho Chi Minh City – Phnom Penh or vice versa

	5 Days 4 Nights	
	Peak	Shoulder
	01 Oct - 31 Mar	01 Apr – 30 Sep
	USD	USD
01 Oct 2022 - 30 Sept 2023 Departures		
Superior Suite	1,649	1,258
Vista Suite	1,879	1,430
Signature Suite	2,109	1,605
Prestige Suite	2,459	1,865
Grande Suite	2,919	2,210
01 Oct 2023 – 30 Sept 2024 Departures		
Superior Suite	1,811	1,380
Vista Suite	2,065	1,570
Signature Suite	2,319	1,763
Prestige Suite	2,704	2,050
Grande Suite	3,212	2,430

Sailing Dates – Mekong Navigator – 5 Days 4 Nights Cruises
Ho Chi Minh City – Phnom Penh

Cruise Code	Direction	Program	Embarkation	Disembarkation
2022				
MN221016	UPSTREAM	4 nights	16 October, 2022	20 October, 2022
MN221127	UPSTREAM	4 nights	27 November, 2022	01 December, 2022
MN221225	UPSTREAM	4 nights	25 December, 2022	29 December, 2022
2023				
MN230115	DOWNSTREAM	4 nights	18 January, 2023	22 January, 2023
MN230212	DOWNSTREAM	4 nights	15 February, 2023	19 February, 2023
MN230219	UPSTREAM	4 nights	19 February, 2023	23 February, 2023
MN230319	UPSTREAM	4 nights	19 March, 2023	23 March, 2023
MN230326	DOWNSTREAM	4 nights	29 March, 2023	02 April, 2023
MN230416	UPSTREAM	4 nights	16 April, 2023	20 April, 2023
MN230423	DOWNSTREAM	4 nights	26 April, 2023	30 April, 2023
MN230917	UPSTREAM	4 nights	17 September, 2023	21 September, 2023
MN230924	DOWNSTREAM	4 nights	27 September, 2023	01 October, 2023
MN231001	UPSTREAM	4 nights	01 October, 2023	05 October, 2023
MN231008	DOWNSTREAM	4 nights	11 October, 2023	15 October, 2023
MN231015	UPSTREAM	4 nights	15 October, 2023	19 October, 2023
MN231126	UPSTREAM	4 nights	26 November, 2023	30 November, 2023
MN231203	DOWNSTREAM	4 nights	06 December, 2023	10 December, 2023
MN231210	UPSTREAM	4 nights	10 December, 2023	14 December, 2023

MN231217	DOWNSTREAM	4 nights	20 December, 2023	24 December, 2023
MN231224	UPSTREAM	4 nights	24 December, 2023	28 December, 2023
2024				
MN240107	UPSTREAM	4 nights	07 January, 2024	11 January, 2024
MN240211	DOWNSTREAM	4 nights	14 February, 2024	18 February, 2024
MN240303	UPSTREAM	4 nights	03 March, 2024	7 March, 2024
MN240407	DOWNSTREAM	4 nights	10 April, 2024	14 April, 2024

Rate condition:

- Prices are in USD per person
- Prices are based on Double Occupancy

Single Accommodation:

- 30% surcharge of Double Occupancy

Included:

- 4 nights onboard the luxurious Mekong Navigator
- Full board including themed dinners, welcome and farewell reception.
- Complimentary house wine for dinner.
- Complimentary local coffee and fine tea selection, soft-drinks, local beer and local spirits
- Complimentary water bottle for excursions
- Complimentary wifi in-room and public areas
- Lotus Cruises exclusive's series of cultural performances, educational talks, food demonstration classes
- English speaking crew and English expert local guides
- All entrance fees, transportation as mentioned in the shore excursion program
- Deluxe Sampons with cold towel service, fresh fruit and tea/coffee service (where applicable)
- Individual VOX listening devices throughout cruise shore excursion program
- Shoe cleaning after excursion
- Welcome drink and cold towel service following excursions
- Suggested gratuities \$65 per passenger
- Transfers from Siem Reap to Kampong Cham and from My Tho to Ho Chi Minh City (Coach transfers)
- Gratuities \$65 per passenger

Not Included:

- Port Charge \$55 per passenger
- Visa. For Upstream cruises only: Cambodia E-Visa will not be accepted at river check point, we recommend to make visa on arrival when you are on the cruise with us, visa cost 40 USD/person)
- Airfare to/from destination
- Premium wine and spirits
- Transfer outside included transportation as provided in the shore excursion program
- Spa treatments, on-board laundry and gift shop items

3. Mekong Navigator FIT Fare Summary in USD - 4 Days 3 Nights Cruises
Phnom Penh – Siem Reap or vice versa

	4 Days 3 Nights	
	Peak	Shoulder
	01 Oct - 31 Mar	01 Apr - 30 Sept
	USD	USD
01 Oct 2022 - 30 Sept 2023 Departures		
Superior Suite	1,246	952
Vista Suite	1,420	1,084
Signature Suite	1,591	1,213
Prestige Suite	1,855	1,408
Grande Suite	2,200	1,669
01 Oct 2023 – 30 Sept 2024 Departures		
Superior Suite	1,368	1,044
Vista Suite	1,560	1,189
Signature Suite	1,748	1,332
Prestige Suite	2,040	1,547
Grande Suite	2,420	1,834

Sailing Dates – Mekong Navigator – 4 Days 3 Nights Cruises
Phnom Penh – Siem Reap

Cruise Code	Direction	Program	Embarkation	Disembarkation
2022				
MN221016	UPSTREAM	3 nights	20 October, 2022	23 October, 2022
MN221127	UPSTREAM	3 nights	01 December, 2022	04 December, 2022
MN221225	UPSTREAM	3 nights	29 December, 2022	01 January, 2023
2023				
MN230115	DOWNSTREAM	3 nights	15 January, 2023	18 January, 2023
MN230212	DOWNSTREAM	3 nights	12 February, 2023	15 February, 2023
MN230219	UPSTREAM	3 nights	23 February, 2023	26 February, 2023
MN230319	UPSTREAM	3 nights	23 March, 2023	26 March, 2023
MN230326	DOWNSTREAM	3 nights	26 March, 2023	29 March, 2023
MN230416	UPSTREAM	3 nights	20 April, 2023	23 April, 2023
MN230423	DOWNSTREAM	3 nights	23 April, 2023	26 April, 2023
MN230917	UPSTREAM	3 nights	21 September, 2023	24 September, 2023
MN230924	DOWNSTREAM	3 nights	24 September, 2023	27 September, 2023
MN231001	UPSTREAM	3 nights	05 October, 2023	08 October, 2023
MN231008	DOWNSTREAM	3 nights	08 October, 2023	11 October, 2023
MN231015	UPSTREAM	3 nights	19 October, 2023	22 October, 2023
MN231126	UPSTREAM	3 nights	30 November, 2023	03 December, 2023
MN231203	DOWNSTREAM	3 nights	03 December, 2023	06 December, 2023
MN231210	UPSTREAM	3 nights	14 December, 2023	17 December, 2023

MN231217	DOWNSTREAM	3 nights	17 December, 2023	20 December, 2023
MN231224	UPSTREAM	3 nights	28 December, 2023	31 December, 2023
2024				
MN240107	UPSTREAM	3 nights	11 January, 2024	14 January, 2024
MN240211	DOWNSTREAM	3 nights	11 February, 2024	14 February, 2024
MN240303	UPSTREAM	3 nights	07 March, 2024	10 March, 2024
MN240407	DOWNSTREAM	3 nights	07 April, 2024	10 April, 2024

Rate condition:

- Prices are in USD per person
- Prices are based on Double Occupancy

Single Accommodation:

- 30% surcharge of Double Occupancy

Included:

- 3 nights onboard the luxurious Mekong Navigator
- Full board including themed dinners, welcome and farewell reception.
- Complimentary house wine for dinner.
- Complimentary local coffee and fine tea selection, soft-drinks, local beer and local spirits
- Complimentary water bottle for excursions
- Complimentary wifi in-room and public areas
- Lotus Cruises exclusive's series of cultural performances, educational talks, food demonstration classes
- English speaking crew and English expert local guides
- All entrance fees, transportation as mentioned in the shore excursion program
- Deluxe Sampans with cold towel service, fresh fruit and tea/coffee service (where applicable)
- Individual VOX listening devices throughout cruise shore excursion program
- Shoe cleaning after excursion
- Welcome drink and cold towel service following excursions
- Transfers from Siem Reap to Kampong Cham and from My Tho to Ho Chi Minh City (Coach transfers)
- Gratuities \$55 per passenger

Not Included:

- Port Charge \$45 per passenger
- Visa. For Upstream cruises only: Cambodia E-Visa will not be accepted at river check point, we recommend to make visa on arrival when you are on the cruise with us, visa cost 40 USD/person)
- Airfare to/from destination
- Premium wine and spirits
- Transfer outside included transportation as provided in the shore excursion program
- Spa treatments, on-board laundry and gift shop items

4. Accommodations:

- All-Suite Luxury Vessel
- 2 Grande Suites with Panoramic French Balcony and Wraparound Veranda (584 Square Feet/54 Square Meters)
- 2 Prestige Suites with Private Balcony (387 Square Feet/36 Square Meters)
- 16 Signature Suites with Private Balcony (291 Square Feet / 27 Square Meters)
- 10 Vista Suites with French Balcony (276 Square Feet / 26 Square Meters)
- 4 Superior Suites with Portholes (256 Square Feet / 24 Square Meters)
- Grande & Prestige Suites Feature Fixed King Beds
- Superior, Vista and Signature Suites can be converted from two twin-size to one queen-size bed
- Luxury Honeycomb Spa Robes with slippers
- All Natural Spa Quality Bath Amenities
- Pillow Menu

- In-room Electronic Safe
- 300-Thread Count Linens with Duvet
- Premium Mattresses
- Welcome flowers arrangement and fresh fruit upon arrival
- Complimentary Wireless Internet in suite and public areas
- Make-Up Mirror
- Multi-Configuration Plugs
- Generous Closet Space and under-Bed Storage
- Alarm Clock
- Hair Dryer
- Flat Screen LCD Television with Satellite International channels
- Mini Bar

5. Additional Amenities for Grande & Prestige Suite Guests:

- Butler Service to Include:
 - Nightly Turndown Service
 - Assistance with Pillow Menu Selection
 - Presentation of Spa-Quality Bath Amenities
 - Ensures Accommodations are Immaculate
 - Polish and Condition Shoes Upon Request
 - Refreshes Ice Bucket
 - Prepare and Pack Luggage Upon Request
 - Scented Bath on Request
- Complimentary One-Hour Spa Treatment Per Guest per journey
- Complimentary Laundry Service
- Complimentary Evening Canapés

2022 – 2023 – 2024 BOOKING CONDITION FIT GUESTS

GROUP AND CHARTER RESTRICTION

Lotus Cruises offers FIT rates that are valid for maximum of **16 paying passengers** (or **maximum 08 cabins**). Please contact Lotus Cruises headquarters or sales office for group rates (charters, group, and series). Different inclusions may apply for group bookings.

CHILD & THIRD PERSON POLICY

Lotus Cruises allows children above 5 years old on board with the following restrictions:

- Maximum one child between 5 and 11.99 years old per cabin sharing bed with parents, 30% of double occupancy fare rate (sharing) if staying in a cabin with two adults; and 75% of double occupancy fare rate (sharing) if staying in a cabin with one adult.
- Above 12 years old adult rate applied.
- Please contact Lotus Cruises for special permission of infants below 5 years old onboard.

NOTE: Children are only allowed on board in accompany by at least one adult. Lotus Cruises is not responsible for the safety of children on board. Parents are always fully reliable for their children and have to supervise and police their children.

TOUR LEADER & GUIDE POLICY

Lotus Cruises' guide services are offered in English language. Lotus Cruises can provide guides in other languages at extra cost. Please contact us in advance to check availability and cost for a personal guide on board.

For tour leader, please contact Lotus Cruises for individual quotation and restriction for tour leader accommodation on Lotus Cruises.

PASSENGER DATA

In order to provide highest standards of service and quality Lotus Cruises request to submit passenger data and details as soon as possible after the receipt of booking confirmation. A passport soft copy, mobile number and hotel information is required. For any delayed submission Lotus Cruises reserves the right to apply a service charge per passenger or to refuse guests' boarding with full cancellation charge.

PAYMENTS

- Booking is made **more than 60 days** prior to departure date

Payment (amount of total booking value)	Payment due date(s)
20 %	Upon confirmation
80 %	60 days prior to cruise date

- Booking is made **less than 60 days** prior to departure date

Payment (amount of total booking value)	Payment due date(s)
100%	Upon confirmation

A booking is automatically released if payments are not received on due date(s).

CANCELLATION

Cancellations or booking amendments must be informed in writing. E-mail cancellation or booking amendments are only effective once re-confirmed by Lotus Cruises. We strongly recommend to advice passenger to purchase travel insurances to cover cancellation cost if any. Lotus Cruises does not cover any costs related to passengers' travelling risk.

Cancellation prior to cruise date	Cancellation charge (of total booking value)
More than 180 days prior	Administration fee 100 USD/pax
Between 180-61 days	20 %
Between 60-31 days	50%
30 days to cruise date or no show	100%

PRE/POST EXTENSION PROGRAM CANCELLATIONS

90 – 61 days prior to the initial sailing date: US\$250 per person;

60 - 0 days prior to the initial sailing date: 100% of the extension program per person cost.

2022-2023-2024 TERMS AND CONDITIONS FIT GUESTS

IMPORTANT NOTICE

Terms and conditions apply to all vessels under Lotus Cruises' operation unless otherwise noted. Any and all information contained herein is in effect at the time of printing and is subject to change at any time.

The transportation of guests and baggage on Lotus Cruises vessels is provided solely by Lotus Cruises and is governed by these terms and conditions.

The Terms and Conditions will be included with your travel documents and contains complete and important information regarding cancellations, itineraries, Lotus Cruises's liability, health and immigration requirements, and other relevant terms and conditions. These Terms and Conditions will apply to persons who have booked a cruise regardless of whether or not they have embarked the vessel.

Itinerary arrival and departure times are always subject to change without notice. Lotus Cruises reserves the right to cancel, alter, advance, postpone or substitute any scheduled sailing or itinerary, substitute another vessel for the scheduled ship, or substitute or cancel scheduled ports of call, which, in its sole judgment and discretion, is justified for any reason, and to do so without liability for any loss whatsoever to guests as a result of said change(s). Additionally, Lotus Cruises reserves the right to cancel reservations and bookings in the event of a full-ship charter, whether or not a deposit or full payment has been received, and in such event, Lotus Cruises' only liability will be to refund to the guest the amount it has received.

Lotus Cruises makes arrangements for transportation, other than cruise passage, only as a booking agent. Lotus Cruises' responsibility does not extend beyond the vessel. In arranging for the transportation of guests to and from the ship, Lotus Cruises does so with independent contractors. Lotus Cruises is not responsible for incidents such as airline cancellations, re-routings or any disruption of scheduled services or accommodation, or lost luggage.

Travel documents will not be dispatched until full and final payment and passenger contact information has been received by Lotus Cruises and cleared. For purposes of this Agreement, Contact Information shall mean a passenger's full name, passport number, address, telephone number (land and mobile), electronic mail address and emergency contact information and any other information as requested by Lotus Cruises. Lotus Cruises must be able to reach each passenger's emergency contact at any time of day. Lotus Cruises must, therefore, be provided with all information to allow Lotus Cruises to do so (such information should include the name, address, electronic mail address (if available) and phone number (including a cell phone number if available) of a parent, guardian, spouse, domestic partner, or other person to contact in the event of an emergency. No passenger will be allowed to embark Lotus Cruises' vessel unless Lotus Cruises has received all information.

CRUISE TARIFF 2022/2023

Lotus Cruises fares cover certain shipboard services including: suit accommodations, shore excursions, onboard meals and entertainment, complimentary beverages aboard ship (including select Free-flow house wines for dinner, and locally

produced spirits, soda, water, coffee and tea throughout the cruise). All fares are quoted in US dollars, are per guest and based on double occupancy. Not included in your cruise tariff are: airfare, hotel accommodations, optional shore excursions, meals ashore, imported mineral water and not included in your cruise tariff are: airfare, hotel accommodations, optional shore excursions, meals ashore, imported mineral water and sodas, fuel charges, any item from the ship boutique or any item or service of a personal nature such as medical care, massages or spa treatments or service of a personal nature such as medical care, massages, spa treatments. Champagne, premium wine and spirit selections are not included in your fare and may not be available at all.

TRAVEL PROFESSIONALS

Travel agents are considered to be the agent of Passenger and not of Carrier. Carrier is not liable for any representation, act or omission of Passenger's travel agent. Passenger's cruise fare is not considered paid until Carrier receives full payment, and the amount thereof is subject to change at any time prior to Carrier's receipt of payment. Passenger shall, at all times, remain liable to Carrier for the price of passage. Carrier reserves the right to refuse embarkation if all charges and surcharges have not been paid in advance of departure.

CHANGES OR CANCELLATION BY LOTUS CRUISES – MINIMUM OCCUPANCY PER CRUISE DEPARTURE

In the event that we are unable to provide cruise service to passengers with confirmed bookings or departures where minimum occupancy has not been reached, Lotus Cruises has the right to cancel the cruise. Lotus Cruises' notice period of cancellation in such events is 60 days prior to a cruise departure date. Minimum occupancy requirements per ship on any cruise that Lotus Cruises' ship is sailing:

Mekong Navigator: 12 paying adults.

Mekong Jewel: 12 paying adults.

Mekong Muse: 10 paying adults

An alternative cruise itinerary (itinerary, departure date and vessel) will be offered subject to availability. If the proposed alternative price is cheaper than the original booked price, Lotus Cruises will refund the difference; or if more expensive than the original booked price, the difference will have to be paid to Lotus Cruises. If the proposed alternative cruise is accepted, the original provided itinerary will be amended accordingly (if applicable) and an updated version will be issued. If the proposed alternative cruise is not accepted within 7 days, Lotus Cruises will cancel the booking and refund all monies paid to Lotus Cruises. Lotus Cruises does not have any further liability or compensation and we are not liable for any incurring third party costs (for example, airfares or other arrangements).

HEALTH AND MEDICAL REQUIREMENTS

All guests are required to report in writing to Lotus Cruises at the time their reservation is made:

1. Any physical or mental condition that may require medical or professional treatment or attention during the voyage
2. Any condition that may render the guest unfit for travel, or that may require special care or assistance
3. Any condition that may pose a risk or danger to the guest or anyone else onboard the ship
4. Any condition that may require oxygen for medical reasons
5. Any intention or need to use a wheelchair cart, other mobility device

By booking passage and by boarding the ship, the guest represents and warrants that he/she is physically and otherwise fit to travel, and that the guest will comply at all times with applicable rules and regulations of the ship and orders and instructions of the ship's officers.

Lotus Cruises reserves the right without liability to require a guest to disembark and/or to refuse to board and transport a guest who, in the judgment of Lotus Cruises or the ship's Captain, is unfit to travel or may require care beyond that which Lotus Cruises is reasonably able to provide.

Lotus Cruises strongly recommends that guests are able to navigate the stairs on board without assistance. Should guests require assistance, they must travel with someone who is able to assist them both ashore and at on board.

Lotus Cruises is unable to offer special assistance. Please note that wheel-on and/or wheel-off access is not available at ports of-call.

BAGGAGE

You may bring aboard the ship as reasonable amount of clothing and personal effects without charge. Baggage for Lotus Cruises guests or guests on our land extension programs must be handled in accordance with regulations of our ground operators. Baggage (exceeding these limitations is subject to the charges as set forth by the individual operators. Airlines are strict with baggage limitations. Guests are encouraged to contact individual airlines for weight limitations.

All baggage must be securely packed and properly and clearly labeled. Liquid, fragile, perishable and other articles not suitably packed are transported at your own risk. Lotus Cruises is not responsible for loss or damage to baggage or any other personal items during air travel or land extension programs. Baggage and personal belongings will be taken off the ship upon guest disembarkation. Under no circumstance will baggage be store onboard without the owner of such baggage being on the vessel. Lotus Cruises is not responsible for baggage stored in shore side facilities.

Under no circumstance may dangerous items (including but not limited to: explosives, firearms, combustible or illegal substances) be taken aboard the ship. We recommend that you hand-carry travel documents (passport, visa, cruise ticket), medications and valuables. These items are the full responsibility of the guest at all times. Lotus Cruises shall not be responsible for the loss of, or damage to, such personal item.

LOST PROPERTY

Lotus Cruises may levy a charge for the return of personal items left on board or lost and subsequently found.

TRAVEL DOCUMENTS

All travel documents (air and cruise tickets, passport and medical insurance information) are the guest's responsibility. It is also the guest's responsibility to obtain any necessary visas and public health documents for all applicable ports and to comply with all customs requirement.

Without the required documents, a guest may be denied boarding and accommodation by Lotus Cruises or the guest may be disembarked during the voyage and Lotus Cruises will not make a refund or be otherwise liable to any guests for such denial of boarding or disembarkation.

In the event that Lotus Cruises as a courtesy, provides information or advice as to necessary travel documents, visas and medical inoculations, guests are still obligated to verify such information with the appropriate government authorities and Lotus Cruises does not warrant or guarantee the accuracy of such information.

Vietnam & Cambodia requires passports to be valid six months beyond intended stay. Please check with the appropriate consulate for specific requirements. Security measures imposed by governments may change from time to time and each guest will be required to comply with them. As a courtesy, we will endeavor to provide each guest with notice of measures that may affect them, but not complying with any such requirements are the sole responsibility of each guest. Please consult your travel professional for advice on such requirements to avoid the loss of boarding privileges.

TAXES, GOVERNMENT FEES/QUASI-GOVERNMENT FEES AND FUEL SUPPLEMENTS

Lotus Cruises reserves the right to pass through to its guests (including fully paid and deposited guest) any taxes and government fees/quasi-government fees that relate specifically to a guest's itinerary. Taxes and Government fees/quasi-government fees include any all fees, charges, surcharges, tolls and taxes imposed by governmental or

quasi-governmental authorities including, but not limited to, customs fees, per person berth taxes or fees, embarkation and/or disembarkation fees at ports, airline transportation fees, dockage fees, and wharf age fees. Lotus Cruises reserves the right to charge a per person fuel supplement in the event that the price of increases up to and including the day of embarkation. Lotus Cruises may collect any taxes, government fees/quasi-government fees and fuel supplement (the 'Surcharge') at the time of booking, prior to sailing or on board the vessel, even if the wise fare has been paid in full. Surcharge will be invoiced accordingly. All fares, and itineraries are subject to change without notice. Additional restrictions may apply. Lotus Cruises reserves the right to correct any errors or omissions.

**SAMPLE LOTUS CRUISES FIT DEPARTURES
FOR MEKONG NAVIGATOR
FROM HOCHIMINH CITY TO SIEM REAP (7-NIGHT/8-DAY CRUISE)
UPSTREAM**

DAY 1 (Sunday) MY THO / EMBARKATION (Dinner)

(14:30) In the afternoon, enjoy a scenic drive from Ho Chi Minh City to My Tho Port, South Vietnam. From there, you will begin your journey aboard the luxurious Mekong Navigator cruise ship. After settling into your well-appointed Suite-cabin, that evening, following a welcome reception, safety briefing, and introduction to key members of our crew, a delicious Vietnamese 'Mekong Delta' Welcome Dinner is served in Le Marche Dining Room.

The Mekong Navigator cruise ship departs My Tho after all guests are on board about 17:00

Overnight mid-river Cai Be area

DAY 2 (Monday) CAI BE / SA DEC (Breakfast / Lunch/ Dinner)

(08:30) Upon arrival to Cai Be, we will be met at the cruise ship by our local sampans. As we board the sampan boats and leave the cruise ship we will cruise amongst a myriad of local boats from the delta provinces. You may see larger boats selling a variety of items, and the stilted houses of Cai Be. Continuing into Cai Be's smaller canals, stops will be made to visit the Ba Duc House, a traditional Vietnamese home and garden, as well as a rice factory, where pop rice candy, rice paper, and other rice products are made. At the factory, you will find a variety of postcards, souvenirs, and lovely oil paintings to buy (US dollars are fine and credit cards are accepted).

The Mekong Navigator cruise ship departs Cai Be area after all guests are back on board about 11:00

The Mekong Navigator cruise ship arrives Sa Dec area about 14:00

(14:00) This afternoon, your sampans return for a leisurely, scenic navigation of the narrow canals of the Mekong, where you will observe daily routines of the villagers en route to the historic town of Sa Dec. In the town of Sa Dec you visit the home of Mr. Huynh Thuy Le, the inspiration of Marguerite Duras' novel, L'Amant (The Lover), as well as the Chinese Temple - Kien An Cung which was built in honor of the Huynh Thuy Le Family. From there, you will begin a walk through the town's market, where you experience the sights, sounds, smells and provides you wonderful photo opportunities of the colorful fresh produce, meat, live fish and seafood for sale.

The Mekong Navigator cruise ship departs Sa Dec area after all guests are back on board about 17:00

Overnight mid-river My An Hung area

DAY 3 (Tuesday) MY AN HUNG / LONG KHANH A ISLAND (Breakfast / Lunch/ Dinner)

(08:30) This morning, we make a short journey from ship to shore by traditional sampan, visiting a typical evergreen farming village on the Mekong Delta, the My An Hung village. We walk through the verdant village, interact with villagers, enjoy fresh coconut in the garden... A local family would invite us for some honey tea and fruit while we enjoy the "don ca tai tu" folk music, followed by an impressive VOVINAM Vietnam Martial Arts performed by the teenagers of the village.

The Mekong Navigator cruise ship departs My An Hung area after all guests are back on board about 11:00

The Mekong Navigator cruise ship arrives Long Khanh A Island area about 15:00

(15:00) In the afternoon, your sampans will bring you to the local island village of Hong Ngu, not far from the Vietnam-Cambodia border. Hong Ngu produces a large number of the traditional, Khmer scarves exported to Cambodia. Woven in many homes around the village, you will have the opportunity to see the weaving process at several homes. Some villagers are also embroidery artists, displaying their art in and around the homes. The inhabitants of this area had only encountered one western visitor prior to the arrival of the Mekong Navigator, and are especially friendly and welcoming. Before returning to the sampans, we will walk around this evergreen island and visit the home of a local War Veteran.

The Mekong Navigator cruise ship departs Long Khanh Island area after all guest back on board about 17:30

Overnight at the border area

DAY 4 (Wednesday) BORDER CROSSING / DAY TO RELAX & ENJOY THE SHIP / CRUISING UPSTREAM (Breakfast / Lunch/ Dinner)

Border Formalities about 07:00

The Mekong Navigator cruise ship departs the Border about 09:30

This morning we sail upstream to enjoy a leisurely cruise and taking in the sights along the Mekong River reaching Phnom Penh in the evening. Some cultural activities are planned on board.

The Mekong Navigator cruise ship arrives at Phnom Penh about 20:00

Overnight docking at Phnom Penh Port

DAY 5 (Thursday) PHNOM PENH (Breakfast / Lunch/ Dinner)

(08:30) In the morning, learn more about the darkest days of Cambodian history. After a scenic 45minute drive from the ship, you arrive at the Choeung Ek killing fields, where you may walk through the fields, visit the small museum and Memorial Stupa, and learn more about the atrocities committed during the Khmer Rouge regime. Before returning to the ship, tour Tuol Sleng (also known as S-21), the former school converted to the main prison and torture headquarters of the Khmer Rouge.

After returning to the ship from the Killing Fields, enjoy a free afternoon in Phnom Penh - shopping, dining at one of the many wonderful restaurants, or exploring the city independently.

(There is a scheduled shuttle coach with your local guide provided from the Port to the Central Market for your shopping time.)

Before dinner, join us on the Sun Deck to watch Cambodian cultural performances including Cambodian's national dance as well as Apsara blessing dance

Overnight docking at Phnom Penh Port

DAY 6 (Friday) PHNOM PENH (Breakfast / Lunch/ Dinner)

(08:30) After breakfast on board this morning, Tuk drivers meet you on the pier for an exciting morning tour of Phnom Penh. You are gently transported along the riverfront to the Royal Palace complex, where you enjoy a leisure walk through the grounds. After viewing Throne Hall and Moonlight Pavilion, you visit the famous Silver Pagoda, home of Cambodia's Emerald Buddha and the Maitreya Buddha, which is encrusted with more than 9,000 diamonds. Your Tuk Tuk is waiting outside to take you on the short ride to the open-air National Museum, housing the largest collection of Angkorian and pre-Angkorian artifacts excavated at the Angkor Temple complex at Siem Reap, as well as other areas around Cambodia.

After returning to the ship, another free afternoon in Phnom Penh or join the optional Excursion with an additional cost.

Optional Afternoon Excursion Tour to visit one of the local silk weaving Villages:

Board a local Boat and cruise about 40 minutes around the Head-lands from the Tonle Sap River back into the Mekong River reaching the Silk weaving area. Get in in-depth information from silk worm raising to weaving the beautiful silk products like silk Sarong, Phamuong, Hol and silk Karma. Returning by boat the same way, whilst cruising along Sisowath Quay and the Royal Palace, during the sunset.

The Mekong Navigator cruise ship departs Phnom Penh about 19:00

Overnight mid river at Angkor Ban

DAY 7 (Saturday) ANGKOR BAN / WAT HANCHEY / KAMPONG CHAM (Breakfast / Lunch/ Dinner)

(08:30) This morning, we will visit the charming village of Angkor Ban. Here, you will have a glimpse into the lives of the local people, starting with a visit to a family's home to see how the locals live, along with an opportunity to meet the family and discuss their lifestyle. Next, you will continue through the village to the local private school, where you will join the children in their classroom and experience what their typical school day is like. You will then walk back through the village to the ship, with an opportunity to take photos along the way, including a brief stop at the local monastery complex.

***The Mekong Navigator cruise ship departs Angkor Ban after all guests on board about 11:00
Arriving Wat Hanchey about 15:00***

(15:00) In the afternoon your excursion will start with a walk up the hill to the local monastery of Wat Hanchey and receive a traditional Buddhist Water Blessing from the resident monks. After enjoying a walk around the monastery and the amazing views of the Mekong River valley, you descend 303 steps and return to the ship.

*For gentle walkers, there is a small coach provided bringing you up and down the hill.

The Mekong Navigator cruise ship departs Wat Hanchey after all guests on board about 17:30

In the evening, you gather in the Sun Deck in front of the Le Salon Lounge this evening for a Farewell Reception with the entire crew, before enjoying a Cambodian Farewell Dinner in Le Mache Dining Room.

The Mekong Navigator cruise ship arrives Kampong Cham port at about 19:00

Overnight docking at Kampong Cham

DAY 8 (Sunday) KAMPONG CHAM / SIEM REAP / DISEMBARKATION (Breakfast/Lunch at rest stop)

Following breakfast, you say goodbye to the crew as you disembark the cruise ship and transfer from Kampong Cham to Siem Reap, Cambodia, with a lunch stop, arriving early afternoon at your hotel in Siem Reap, Cambodia.

Coaches departs Kampong Cham to Siem Reap about 08:30

Itinerary Changes and Amendments

Every effort will be made to follow the itinerary provided, however due the nature of the river and the rural environments we are traveling through, there will be times where modifications are required to the itinerary without prior notice. In such cases, we will do everything we can to make sure the locations visited, and excursions taken are similar to the ones originally planned.

In the event of political problems, natural disasters like earthquakes or even disruption due to weather, festivals or things beyond our control we reserve the right to make changes to the itinerary or an activity in order to maximize the passenger's experience.

**SAMPLE LOTUS CRUISES FIT DEPARTURES
FOR MEKONG NAVIGATOR
FROM HO CHI MINH CITY TO PHNOM PENH (4-NIGHT/5-DAY CRUISE)
UPSTREAM**

DAY 1 (Sunday) MY THO / EMBARKATION (Dinner)

(14:30) In the afternoon, enjoy a scenic drive from Ho Chi Minh City to My Tho Port, South Vietnam. From there, you will begin your journey aboard the luxurious Mekong Navigator cruise ship. After settling into your well-appointed Suite-cabin, that evening, following a welcome reception, safety briefing, and introduction to key members of our crew, a delicious Vietnamese 'Mekong Delta' Welcome Dinner is served in Le Marche Dining Room.

The Mekong Navigator cruise ship departs My Tho after all guests are on board about 17:00

Overnight mid-river Cai Be area

DAY 2 (Monday) CAI BE / SA DEC (Breakfast / Lunch/ Dinner)

(08:30) Upon arrival to Cai Be, we will be met at the cruise ship by our local sampans. As we board the sampan boats and leave the cruiseship we will cruise amongst a myriad of local boats from the delta provinces. You may see larger boats selling a variety of items, and the stilted houses of Cai Be. Continuing into Cai Be's smaller canals, stops will be made to visit the Ba Duc House, a traditional Vietnamese home and garden, as well as a rice factory, where pop rice candy, rice paper, and other rice products are made. At the factory, you will find a variety of postcards, souvenirs, and lovely oil paintings to buy (US dollars are fine and credit cards are accepted).

The Mekong Navigator cruise ship departs Cai Be area after all guests are back on board about 11:00

The Mekong Navigator cruise ship arrives Sa Dec area about 14:00

(14:00) This afternoon, your sampans return for a leisurely, scenic navigation of the narrow canals of the Mekong, where you will observe daily routines of the villagers en route to the historic town of Sa Dec. In the town of Sa Dec you visit the home of Mr. Huynh Thuy Le, the inspiration of Marguerite Duras' novel, L'Amant (The Lover), as well as the Chinese Temple - Kien An Cung which was built in honor of the Huynh Thuy Le Family. From there, you will begin a walk through the town's market, where you experience the sights, sounds, smells and provides you wonderful photo opportunities of the colorful fresh produce, meat, live fish and seafood for sale.

The Mekong Navigator cruise ship departs Sa Dec area after all guests are back on board about 17:00

Overnight mid-river My An Hung area

DAY 3 (Tuesday) MY AN HUNG / LONG KHANH A ISLAND (Breakfast / Lunch/ Dinner)

(08:30) This morning, we make a short journey from ship to shore by traditional sampan, visiting a typical evergreen farming village on the Mekong Delta, the My An Hung village. We walk through the verdant village, interact with villagers, enjoy fresh coconut in the garden... A local family would invite us for some honey tea and fruit while we enjoy the "don ca tai tu" folk music, followed by an impressive VOVINAM Vietnam Martial Arts performed by the teenagers of the village.

The Mekong Navigator cruise ship departs My An Hung area after all guests are back on board about 11:00

The Mekong Navigator cruise ship arrives Long Khanh A Island area about 15:00

(15:00) In the afternoon, your sampans will bring you to the local island village of Hong Ngu, not far from the Vietnam-Cambodia border. Hong Ngu produces a large number of the traditional, Khmer scarves exported to Cambodia. Woven in many homes around the village, you will have the opportunity to see the weaving process at several homes. Some villagers are also embroidery artists, displaying their art in and around the homes. The inhabitants of this area had only encountered one western visitor prior to the arrival of the Mekong Navigator, and are especially friendly and welcoming. Before returning to the sampans, we will walk around this evergreen island and visit the home of a local War Veteran.

The Mekong Navigator cruise ship departs Long Khanh Island area after all guest back on board about 17:30

Overnight at the border area

DAY 4 (Wednesday) BORDER CROSSING / DAY TO RELAX & ENJOY THE SHIP / CRUISING UPSTREAM (Breakfast / Lunch/ Dinner)

Border Formalities about 07:00

The Mekong Navigator cruise ship departs the Border about 09:30

This morning we sail upstream to enjoy a leisurely cruise and taking in the sights along the Mekong River reaching Phnom Penh in the evening. Some cultural activities are planned on board.

The Mekong Navigator cruise ship arrives at Phnom Penh about 20:00

Overnight docking at Phnom Penh Port

DAY 5: Thursday PHNOM PENH (Breakfast)

Following breakfast, the crew bid farewell as guests are invited to disembark in Phnom Penh, Cambodia.

Itinerary Changes and Amendments

Every effort will be made to follow the itinerary provided, however due the nature of the river and the rural environments we are traveling through, there will be times where modifications are required to the itinerary without prior notice. In such cases, we will do everything we can to make sure the locations visited, and excursions taken are similar to the ones originally planned.

In the event of political problems, natural disasters like earthquakes or even disruption due to weather, festivals or things beyond our control we reserve the right to make changes to the itinerary or an activity in order to maximize the passenger's experience.

**SAMPLE LOTUS CRUISES FIT DEPARTURES
FOR MEKONG NAVIGATOR
FROM PHNOM PENH TO SIEM REAP (3-NIGHT/4-DAY CRUISE)
UPSTREAM**

DAY 1 (Thursday) PHNOM PENH (Lunch/ Dinner)

Embark in the late morning and lunch onboard. In the afternoon, guests are free to further explore Phnom Penh. Alternatively, guests can opt to go shopping or sample the city's vibrant restaurants and bars.

Pre-dinner cultural entertainment is provided on the Sun Deck as guests enjoy a performance by local children of Aspara, the Khmer national dance and other traditional folk dances.

Overnight docking at Phnom Penh Port

DAY 2 (Friday) PHNOM PENH (Breakfast / Lunch/ Dinner)

(08:30) After breakfast on board this morning, Tuk drivers meet you on the pier for an exciting morning tour of Phnom Penh. You are gently transported along the riverfront to the Royal Palace complex, where you enjoy a leisure walk through the grounds. After viewing Throne Hall and Moonlight Pavilion, you visit the famous Silver Pagoda, home of Cambodia's Emerald Buddha and the Maitreya Buddha, which is encrusted with more than 9,000 diamonds. Your Tuk Tuk is waiting outside to take you on the short ride to the open-air National Museum, housing the largest collection of Angkorian and pre-Angkorian artifacts excavated at the Angkor Temple complex at Siem Reap, as well as other areas around Cambodia.

After returning to the ship, another free afternoon in Phnom Penh or join the optional Excursion with an additional cost.

Optional Afternoon Excursion Tour to visit one of the local silk weaving Villages:

Board a local Boat and cruise about 40 minutes around the Head-lands from the Tonle Sap River back into the Mekong River reaching the Silk weaving area. Get in in-depth information from silk worm raising to weaving the beautiful silk products like silk Sarong, Phamuong, Hol and silk Karma. Returning by boat the same way, whilst cruising along Sisowath Quay and the Royal Palace, during the sunset.

The Mekong Navigator cruise ship departs Phnom Penh about 19:00

Overnight mid river at Angkor Ban

DAY 3 (Saturday) ANGKOR BAN / WAT HANCHEY / KAMPONG CHAM (Breakfast / Lunch/ Dinner)

(08:30) This morning, we will visit the charming village of Angkor Ban. Here, you will have a glimpse into the lives of the local people, starting with a visit to a family's home to see how the locals live, along with an opportunity to meet the family and discuss their lifestyle. Next, you will continue through the village to the local private school, where you will join the children in their classroom and experience what their typical school day is like. You will then walk back through the village to the ship, with an opportunity to take photos along the way, including a brief stop at the local monastery complex.

The Mekong Navigator cruise ship departs Angkor Ban after all guests on board about 11:00

Arriving Wat Hanchey about 15:00

(15:00) In the afternoon your excursion will start with a walk up the hill to the local monastery of Wat Hanchey and receive a traditional Buddhist Water Blessing from the resident monks. After enjoying a walk around the monastery and the amazing views of the Mekong River valley, you descend 303 steps and return to the ship.

*For gentle walkers, there is a small coach provided bringing you up and down the hill.

The Mekong Navigator cruise ship departs Wat Hanchey after all guests on board about 17:30

In the evening, you gather in the Sun Deck in front of the Le Salon Lounge this evening for a Farewell Reception with the entire crew, before enjoying a Cambodian Farewell Dinner in Le Mache Dining Room.

The Mekong Navigator cruise ship arrives Kampong Cham port at about 19:00

Overnight docking at Kampong Cham

DAY 4 (Sunday) KAMPONG CHAM / SIEM REAP / DISEMBARKATION (Breakfast/Lunch at rest stop) Following breakfast, you say goodbye to the crew as you disembark the cruise ship and transfer from Kampong Cham to Siem Reap, Cambodia, with a lunch stop, arriving early afternoon at your hotel in Siem Reap, Cambodia.

Coaches departs Kampong Cham to Siem Reap about 08:30

Itinerary Changes and Amendments

Every effort will be made to follow the itinerary provided, however due the nature of the river and the rural environments we are traveling through, there will be times where modifications are required to the itinerary without prior notice. In such cases, we will do everything we can to make sure the locations visited, and excursions taken are similar to the ones originally planned.

In the event of political problems, natural disasters like earthquakes or even disruption due to weather, festivals or things beyond our control we reserve the right to make changes to the itinerary or an activity in order to maximize the passenger's experience.

MEKONG NAVIGATOR FACTSHEET

BOUTIQUE LUXURY RIVER CRUISE ON THE MEKONG

Lotus incorporates every detail there is to love about Vietnam and Cambodia in its authentic approach to luxury river travel.

BUILT	2014
PORT OF EMBARKATION	My Tho (Vietnam), Phnom Penh (Cambodia) and Siem Reap (Cambodia)
ENGINES	2 x Caterpillars C18 Tier 2
VESSEL'S REGISTRY	Vietnam
TYPE OF VESSEL	River Expedition
GROSS REGISTERED TONS	1.611 tons
VESSEL LENGTH	70 meters / 230 feet
BREADTH	12.7 meters / 43 feet
HEIGHT	12 meters / 39 feet
DRAFT	1.8 meters / 6 feet
CRUISING SPEED	10 knots
ELECTRICITY	380 volts/220 volts/24 volts/ 12 volts
WATER	Reverse osmosis and UV water treatment plant
Air Condition	Central AC in public area Privately controlled air-conditioning in each suite
SHIPBOARD ENTERTAINMENT	Cultural shows, Crew dance Satellite Cable TV, USB
GUEST-TO-STAFF RATIO	1.5
GUESTS	68
STAFF	40
CREW NATIONALITIES	Vietnamese, Cambodian
CABINS	Passengers are accommodated in 34 spacious Suites
Orchid Deck (Upper Deck)	20 suites 02 x Grande Suite with wrap-around Veranda (584 Square Feet/54 Square Meters including veranda with 188 sq ft/18sqm), only Double standard room. 02 Prestige Suite with Private Balcony (387 Square Feet/36 Square Meters including balcony with 70 sqft/7sqm), only Double standard room. 16 Signature Suite with Private Balcony (291 Square Feet / 27 Square Meters including balcony with 53 sqft/5sqm), Double or Twin standard room.
Lotus Deck (Main Deck)	10 suites 10 Vista Suite with French Balcony (276 Square Feet / 26 Square Meters), Double or Twin standard room.
Jasmin Deck (Lower Deck)	04 Suites 04 Superior Suite with Portholes (256 Square Feet / 24 Square Meters), Double or Twin standard room.
CABIN FEATURES	King size bed that can be converted to twins, wooden floor, high ceiling (2.4 m/ 8 ft from floor to ceiling) private balcony or French balcony, large double closets, chest of drawers, private safety box, walk-in shower and rainforest showerhead, professional hairdryer, and all- spa quality organic natural hair and bath amenities, pillow menu...
SOCIAL AREAS	Le Marche Dining Hall Le Salon lounge and outside shaded lounge with daybeds Indoor cinema at Le Salon Observation deck

	Library/ Games room Full equipped Gym La Vie Spa Boutique
INTERNET	Complimentary wifi internet throughout the cruise
LAUNDRY	Complimentary service for guests in Grande and Signature suites (no dry cleaning on board). Charged for other types of suites
SAFETY	Float life rafts, life jackets, flares and signals, fire extinguishers and smoke detectors in each cabin and automatic defibrillator on board.
Currency on board	US dollars
Credit cards accepted	Major Credit Cards Accepted

ACCOMODATIONS GRANDE SUITE



Located in the front of the cruiser on the Orchid Deck (upper deck), our two Grande Suites offer the most luxurious environments onboard. Guests in the Grande Suite will enjoy panoramic river views through floor to ceiling glass windows, a private balcony with a generous seating area, a fully stocked and complimentary minibar, complimentary laundry service, and other amenities that are exclusive to Grande Suite guests.

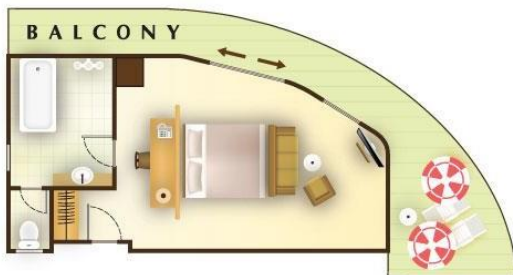

(584 Square Feet/54 Square Meters including veranda with 188 sq ft/18sqm), only Double standard room

- Spacious private balcony with large panoramic floor-to-ceiling
- French doors
- Spacious seating area
- King-size bed
- Marble bathroom with a spa-quality tub and separate rainfall shower
- Writing desk

- Movies and music entertainment channels
- Minibar restocked daily with local beer, soft drink and water

Daily Butler Service which includes:

- Nightly turndown service
- Assistance with selection on the pillow menu
- Presentation of bathroom amenity options
- Demonstration of movie system
- Polishing and conditioning of shoes, upon request
- Ice bucket replenishment
- Unpacking and packing of luggage, upon request
- A preparation of a special scented bath, upon request
- Complimentary one hour La Vie spa treatment
- Complimentary laundry service
- Complimentary evening canapés

ACCOMODATIONS PRESTIGE SUITE



Located mid-ship on the Orchid Deck (upper deck), Prestige Suites designed for comfortable living with private balcony. The Prestige Suites provide an expansive bathroom with soaking tub and premium bath amenities, living area with sofa, and daily butler service.



2 x Prestige Suite with Private Balcony

(387 Square Feet/36 Square Meters including balcony with 70 sqft/7sqm), only Double standard room

- Spacious private balcony with large panoramic floor-to-ceiling
- French doors
- Spacious seating area
- King-size bed
- Marble bathroom with a spa-quality tub and separate rainfall shower
- Writing desk
- Hair dryer

- Flat screen LCD television with news, sports, movies and infotainment channels
- Minibar restocked daily with local beer, soft drink and water

Daily Butler Service which includes:

- Nightly turndown service
- Assistance with selection on the pillow menu
- Presentation of bathroom amenity options
- Demonstration of movie system
- Polishing and conditioning of shoes, upon request
- Ice bucket replenishment
- Unpacking and packing of luggage, upon request
- A preparation of a special scented bath, upon request
- Complimentary one hour La Vie spa treatment
- Complimentary laundry service
- Complimentary evening canapé

ACCOMODATIONS

SIGNATURE SUITE



Located on the Orchid Deck (upper deck), Signature Suites provide guests spacious living space including a private balcony where guests enjoy the charms of the mighty Mekong delta. Signature Suites are outfitted with two twin-size bed or one queen-size bed, upon request.

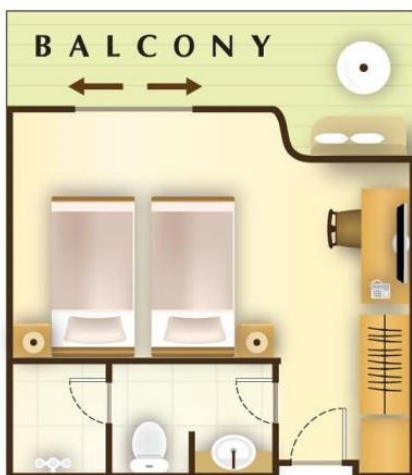

16 x Signature Suite with Private Balcony

(291 Square Feet / 27 Square Meters including balcony with 53 sqft/5sqm), Double or Twin standard room

- Spacious private balcony with large panoramic floor-to-ceiling
- French doors
- Seating area
- Queen-size or Twin beds
- Luxury marble bathroom with rainfall shower
- Writing desk
- Hair dryer
- Flat screen LCD television with news, sports, movies and infotainment channels
- Minibar restocked daily

ACCOMODATIONS

VISTA SUITE



Located on the Lotus Deck (Main Deck), Vista Suites provide guests with French balcony with a spacious seating area, perfect for enjoying the dramatic sunsets along the Mekong River. Vista Suites are outfitted with two twin-size beds or one queen-size bed, upon request.

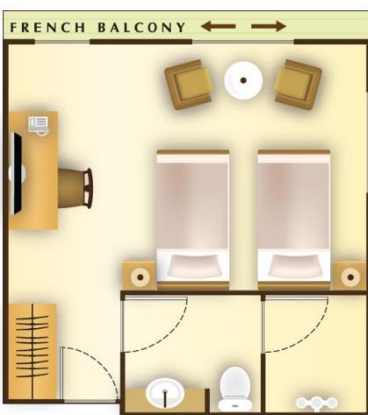

10 x Vista Suite with French Balcony

(276 Square Feet / 26 Square Meters), Double or Twin standard room

- Private balcony with large panoramic floor-to-ceiling
- French doors
- Seating area
- One queen-size or two twin beds
- Luxury marble bathroom with rainfall shower
- Writing desk
- Hair dryer
- Flat screen LCD television with news, sports, movies and infotainment channel
- Minibar restocked daily



ACCOMODATIONS

SUPERIOR SUITE

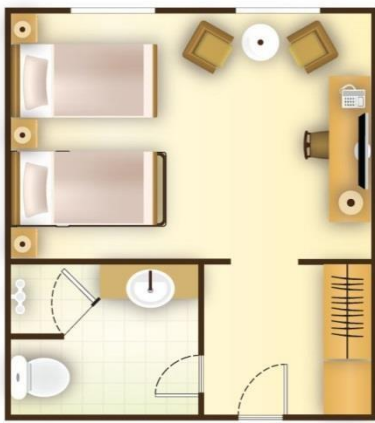

4 x Superior Suite with Portholes

(256 Square Feet / 24 Square Meters), Double or Twin standard room

- Seating area
- Queen-size or Twin beds
- Luxury marble bathroom with rainfall shower
- Writing desk
- Hair dryer
- Flat screen LCD television with news, sports, movies and infotainment channels
- Minibar restocked daily



MEKONG NAVIGATOR

DECK PLAN



SIDE ELEVATION

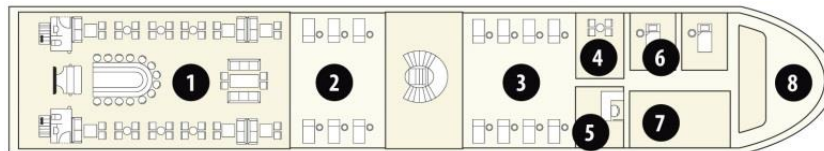

SUN DECK

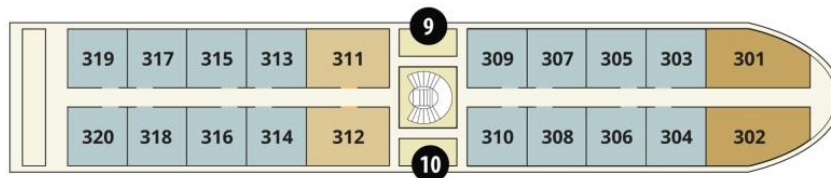

ORCHID DECK

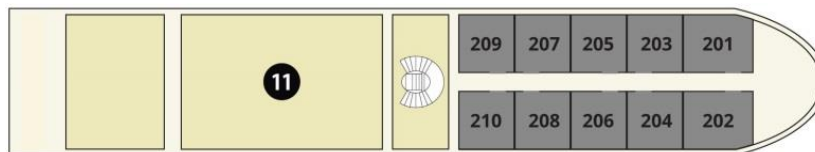

LOTUS DECK

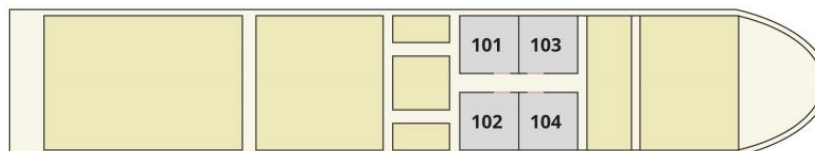

JASMINE DECK

■ Grande Suite

■ Prestige Suite

■ Signature Suite

■ Vista Suite

■ Superior Suite

- | | | | |
|--------------------|-------------------|--------------|------------------------|
| ① Le Salon | ④ La Bibliotheque | ⑦ Gym | ⑩ Gift Shop |
| ② Observation Deck | ⑤ Computer Center | ⑧ Wheelhouse | ⑪ Le Marché Restaurant |
| ③ Sun Deck | ⑥ La Vie Spa | ⑨ Office | |

SHIP STATS

BUILT: 2014
LENGTH: 70m (230ft)
BREADTH 13m (43ft)

DRAFT: 1.8m (6ft)
VOLTAGE: 220 volts
GUESTS: 68

CREW: 44
ENGINES: 2x Caterpillar C18 Tier 2
CRUISING SPEED: 11 knots

CRUISE
World

Contact Cruise World on 09 917 4440 | 0800 500 732
info@cruiseworld.co.nz | www.cruiseworld.co.nz