



LUXURY EXPEDITIONS & YACHT-STYLE VOYAGES

*Japan 2024*









# Contents

Japan through the eyes of Ryo Ijichi	p. 3
<hr/>	
Expedition on the Kitamae route	p. 6
Cultural & natural treasures of Japan by sea	p. 6
Japan, natural archipelago & secular heritage	p. 6
Expedition in the Seto Inland Sea	p. 7
Kyūshū's secret islands and ancestral heritage	p. 7
Japanese subtropical islands	p. 7
Odyssey in the heart of subtropical islands	p. 8
<hr/>	
Ten reasons to sail with PONANT	p. 9
Welcome on Board	p. 14

# Through the eyes of Ryo Ijichi

## A different idea of Japan

Ryo Ijichi is a naturalist guide specialising in the polar regions, who joined PONANT in 2013. Today he is an expedition leader and commercial manager for Japan and Korea, and enjoys sharing his knowledge as much as he does exploring his native region.



*"People often think of Japan as modern Tokyo and traditional Kyoto, so I designed the routes in this region to demonstrate that my country is full of remarkable, diverse places. You may not know it, but each region has its own culture, tradition and gastronomy. As an island state, Japan was originally more connected by sea than by land. Most of the cities, the gateways to these regions, therefore faced the ocean. Imagine what a great playground this is for an expedition ship discovery. We decided to link these ancient towns together, and access some beaches or small villages by inflatable boat, a first for an expedition ship in Japan. Guests will be able to visit the picturesque village of Sakitsu, which during the 300-year Edo period was able to hide its then forbidden practice of Christianity. They will also*

*be able to observe the sumptuous coral reefs and lush mangroves around the subtropical islands of Okinawa. A visit to the fishing village of Ine will take them back in time to the miraculously preserved traditional wooden stilt houses. And to fully reveal the charms of the different regions of the archipelago, what better way than to immerse yourself in the daily life of the Japanese people by interacting with them, discovering new dishes that will then be cooked on board or falling in love with the local crafts? Although words are sometimes not necessary, we make sure that language is not an obstacle, thanks to our multilingual guides. I hope that the guests will be able to make connections and, above all, take with them a completely different idea of this unexpectedly rich country from their trip."*





### ‘Sacred Island’ of Miyajima

Considered one of Japan’s most beautiful sites, the UNESCO World Heritage Site of Miyajima Island is home to the Itsukushima Shinto shrine, founded in 593, and its famous vermilion *torii* (gate) rising to 16 metres. To add to the spiritual aura of this special place, 500 deer roam freely in the park, with the lush forests of Mount Misen as a backdrop.

*Itineraries: Expedition in the Seto Inland Sea, p. 7.*

### Christian sites in Japan

Imported by Western missionaries and then banned during the Edo era, the Christian religion manifests in a particular way in Japan, born from a need to protect oneself from persecution. Some villages are home to relics and churches, now grouped together and classified as UNESCO heritage sites under the name ‘hidden Christian sites in the Nagasaki region’.

*Itineraries: Kyūshū’s secret islands and ancestral heritage, p. 7; Japan, natural archipelago and secular heritage, p. 6.*

400

centenarians live in Okinawa, a Japanese archipelago known for offering its inhabitants the longest life expectancy in the world: 90 years for women and 84 years for men. Quality and freshness of food, mutual aid, attention to the well-being of the elderly, and other factors could explain this astonishing longevity.

*Itineraries: Japanese subtropical islands, p. 7; Odyssey in the heart of Japan’s subtropical islands, p. 8.*



### Little-known ports in South Korea

The coastal cities of South Korea are on a par with their Japanese neighbours. Dominated by the Hallasan volcano, the country’s highest peak, Jeju is awe-inspiring with its beautiful waterfalls and lava tunnels. Yeosu’s naval past is fascinating, as are its lush green surroundings. In Busan, the Haedong Yonggungsa temple on the seafront provides an ideal setting for contemplation.

*Itineraries: all routes on pp. 6 & 7- except Japanese subtropical islands;*





JAPAN LIKE  
YOU'VE NEVER  
SEEN IT



# Expedition on the Kitamae route



Otaru • Osaka | 11 nights | *Le Soléal*: 9th April 2024 | from AU\$16,770<sup>(1)</sup>



## Highlights:

In the footsteps of the merchants of the *Kitamae* route • Brand-new ports of call in Wajima, Miyazu, Uradome Coast and Shimonoseki • All-new crossings of the Kanmon and the Kurushima Straits, emblematic passageways on the *Kitamae* maritime route • Discovering the local arts and crafts of Wajima, famous for Kiriko lanterns and Wajima lacquerware • The varied landscapes of the Japanese shores, including the unexpected, majestic sand dunes in Tottori • Enjoying local cuisine, from rich seafood to sake.

## Cultural and natural treasures of Japan by sea



Maizuru • Hakodate | 7 nights | *Le Soléal*: 21st May 2024 | from AU\$9,750<sup>(1)</sup>



## Highlights:

Engaging discussions onboard with two Smithsonian Journeys Experts • The ancient centre of Silla culture at Gyeongju, a UNESCO World Heritage site • Award-winning landscape gardens, including the world famous Kenroku-en Garden • The geisha district and teahouses of Kanazawa • Stunning Buddhist temples in Busan, including the largest Buddha statue in Asia • Outstanding modern Japanese paintings at the Adachi Museum in Matsue • Extensive opportunities to learn about and purchase exquisite handicrafts.

# Japan, natural archipelago and secular heritage

Kagoshima • Kobe | 8 nights | *Le Jacques-Cartier*: 4th May 2024 | from AU\$12,840<sup>(1)</sup>



## Highlights:

The exceptional presence of Belgian journalist and writer Christine Ockrent • UNESCO sites: 'the hidden Christian sites in the Nagasaki region', in Sakitsu and Kamigoto; Yakushima Island • Brand-new ports of call in the Koshikijima Islands, on Kamigoto and in the island region of Amakusa • All-new crossings of the Kanmon and the Kurushima Straits, emblematic passageways on the *Kitamae* maritime route • The discovery of Japan's Christian history, a religion banned during the Edo period.

NEW



# Expedition in the Seto Inland Sea



**Kobe • Fukuoka** | 7 nights | *Le Jacques-Cartier*: 30th March 2024 | from AU\$10,600<sup>(1)</sup>



## Highlights:

Discovering the cultural richness of Japan's oldest sea route, dating back to the 7th century • Varied landscapes along the Seto Inland Sea, offering stunning contrasts between land and sea • Itsukushima's Shinto Grand Sanctuary, a UNESCO World Heritage Site, whose entrance is guarded by a magnificent vermilion *torii* • Enjoying a local cuisine rich in seafood and taste local saké • In Hagi, the many *Hagi-yaki* ceramics workshops will introduce you to the region's ancient art • Exploring the incredible diversity of the local flora and fauna.

# Kyūshū's secret islands and ancestral heritage



**Kagoshima • Fukuoka** | 7 nights | *Le Jacques-Cartier*: 20th April 2024 | from AU\$8,900<sup>(1)</sup>

**Fukuoka • Kagoshima** | 7 nights | *Le Jacques-Cartier*: 27th April 2024 | from AU\$8,900<sup>(1)</sup>



## Highlights:

Discovering the western part of the island of Kyūshū, at the intersection of Western and Japanese traditions • UNESCO sites: 'the hidden Christian sites in the Nagasaki region' in Sakitsu and Kamigoto; Yakushima Island, a nature sanctuary • Brand-new ports of call in the Koshikijima Islands, on Kamigoto and Jeju, and in the island region of Amakusa • The exploration of Japan's Christian history, a religion banned during the Edo period • Varied landscapes including steep cliffs, monumental waterfalls, virgin forests, tea plantations, geological formations and verdant peaks.

**27th April departure:** the stop in Iki Island is replaced by a stop in Nagasaki.



# Japanese subtropical islands



**Naha • Keelung** | 7 nights | *Le Jacques-Cartier*: 16th March 2024 | from AU\$8,030<sup>(1)</sup>

**Fukuoka • Keelung** | 7 nights | *Le Jacques-Cartier*: 6th April 2024 | from AU\$8,420<sup>(1)</sup>

**Keelung • Kagoshima** | 7 nights | *Le Jacques-Cartier*: 13th April 2024 | from AU\$8,990<sup>(1)</sup>

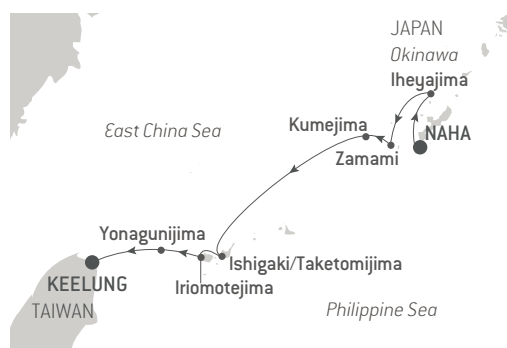

16th March itinerary.

## Highlights:

Exploring the culture of Okinawa: visit to a traditional village in the Iriomote-Ishigaki National Park, traditional *Eisa* drumming show (Iheyajima) • Varied landscapes of the subtropical islands: white sandy beaches, crystal-clear waters, coral reefs, tropical forest, mangroves, rivers, cliffs, caves, waterfalls • Local distillery visit and opportunity to taste the local cuisine of Okinawa • Possibility of diving (PADI Advanced Open Water Diver or equivalent), and of snorkelling with your expedition team.

**Every voyage has its own uniqueness!**  
Find out more about each of the three routes.





# Odyssey in the heart of Japan's subtropical islands

Ha Long • Naha | 12 nights | *Le Jacques-Cartier*: 4th March 2024 | from AU\$15,610<sup>(1)</sup>



## Highlights:

Discovering three Japanese archipelagoes: Okinawa, Yaeyama and Sakishima • UNESCO World Heritage Site: Iriomotejima island • Varied landscapes including white sandy beaches, crystal-clear waters, coral reefs, tropical forest, mangroves, rivers, cliffs, caves, waterfalls • Exploring the culture of Okinawa: visit to a traditional village and local distillery in the Iriomote-Ishigaki National Park, traditional *Eisa* drumming show (Iheyajima) • Enjoying the beautiful beaches on the islands of Zamami and Kumejima • Possibility of diving (PADI Advanced Open Water Diver or equivalent), and of snorkelling with your expedition team.



Tropical Expedition



Expedition team



Lecturer



Guest of honour



Diving







# TEN REASONS to sail with PONANT

## The expedition experience

To plan our expedition voyages, our experts have been exploring the world in search of natural and cultural wonders for 35 years. They meet with local populations and authorities, and assess the safety levels in the areas they visit. On each expedition, the expedition team are at hand to share their knowledge of each region. They also organise safe landings and excursions based on the opportunities that arise each day.







## Travelling is an art

Each season, we design meaningful trips inspired by four major themes: Planet, Culture, Lifestyle, and Geopolitics. In order to offer you unique experiences, we rely on the expertise of our renowned partners, who are represented on board by inspiring personalities: artists, historians, curators, researchers, journalists, essayists and others.

## Working towards more sustainable tourism

By way of our Foundation and our PONANT Blue Horizon and PONANT Science programmes, we are striving to reduce our impact on the terrestrial and marine environments and to contribute to international scientific research. Hybrid propulsion, recycling and waste and water treatment, environmental impact studies, collaborative construction with local populations, hosting scientists on board *Le Commandant Charcot*... Sustainable development plays an integral role in the way we design our ships and plan our voyages, but it also shapes the knowledge we share with you, our guests, who are the future ambassadors of each region we visit.

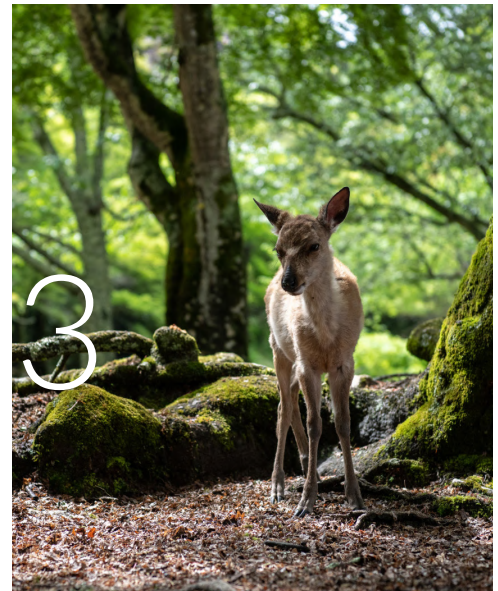

## Conscious travels

In the polar regions, we are members of the IAATO and AECO: regulatory organisations that bring together different stakeholders to promote more responsible tourism. We have also made commitments at an international level, and are proud to be part of the UN programme to ban single-use plastics.

We have earned numerous labels as a result of our actions, and our entire fleet has been awarded Cleanship certification by Bureau Veritas.

## A safe and modern fleet

We are one of only a few companies to sail under the French flag, which represents the highest level of safety. We respect strict specifications regarding crew training, health and safety protocols, and regular checks on our vessels. Designed on a more intimate scale, with just 16 to 165 staterooms, our ships are equipped with the most advanced technology for safe and responsible sailing.



## Lifestyle

On board, the restaurants, bars and lounges welcome you into a warm ambiance, complete with live music. All our ships are equipped with outdoor swimming pools (except *Le Ponant*) and wellness areas with fitness rooms, as well as spas and hairdressing salons offering expert treatments in collaboration with renowned brands (Clarins, Diptyque, Biologique Recherche, Sothys). The theatre is the place to be for all your expedition briefings, as well as for film and documentary screenings, lectures and performances.

## On the PONANT table

Every day, delightful surprises await with a bountiful selection of dishes created with Ducasse Conseil. On the menu, you will find refined breakfasts, à la carte dishes and diverse buffets, home-made pastries, bread prepared and baked on board, and a range of afternoon teas and luxury product tastings (*pata negra*, caviar, gravlax salmon, etc.).





## A complete package

On our voyages, everything is included: full board; drinks (excluding the premium menu); room service; internet access; entertainment and conferences; access to the fitness area, hammam and sauna; and water activities (except diving). For expedition, help from our naturalist guides, excursions, outings and zodiac landings are included.



## Tailor-made journey

With our 'à la carte' service, you can book pre or post excursions and additional hotel nights with the help of our advisors. For certain hard-to-reach destinations, we offer private flights and land transportation.

As soon as you make your reservation, you can download the PONANT application to help you prepare for your trip and to use while on board.

## Your advantages

Solo travellers, family and friends, honeymooners, couples celebrating wedding anniversaries, adventurers embarking on back-to-back voyages, or people travelling as part of the referral program or the PONANT Yacht Club loyalty program: there are plenty of benefits for every guest.

Discover all our  
available offers:







A photograph of a smiling couple on a ship's deck. The man, with grey hair and a beard, is in the foreground wearing a dark blue shirt and holding a glass of red juice with a straw. The woman, with blonde hair, is behind him wearing a light-colored blazer and holding a glass of white wine. They are both looking towards the camera. The background shows the ocean and a bright sky.

WELCOME  
ON BOARD





## The Sisterships

As yachts on a human scale, with just 122 or 132 staterooms *Le Boréal*, *L'Austral*, *Le Soléal* and *Le Lyrial* can gain access to isolated places and ports reserved for small vessels.

They are thus faithful to the PONANT DNA: **exploring the world** with constantly renewed curiosity.

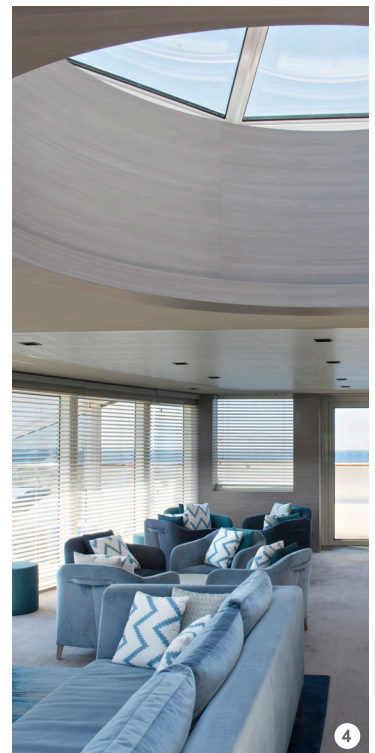





1. Spa, *Le Lyrial*
2. The Grill Restaurant, deck 6, *Le Lyrial*
3. The swimming pool on deck 6
4. The Observatory lounge, *Le Boréal*
5. The library

6. *Le Boréal*
7. Prestige Stateroom, *Le Lyrial*
8. Prestige Stateroom Balcony, *Le Boréal*
9. Prestige Stateroom, *L'Austral*

## Amenities

- Individually controlled airconditioning
- Stateroom layout: king-size bed, or twin beds, communicating Staterooms available (children welcome)
- Minibar
- Flat-screen satellite TV
- Video on demand
- Bose Bluetooth speaker
- Safe

- Diptyque bath products
- Dressing table, bath robes, hairdryer
- Direct line telephone
- 110V American (two flat pins)/220V European (round sockets with two round pins)
- 24hr room service
- Inclusive Wifi internet access\*

*\*Depending on the navigation areas, the Wifi may not be accessible for reasons beyond our control.*



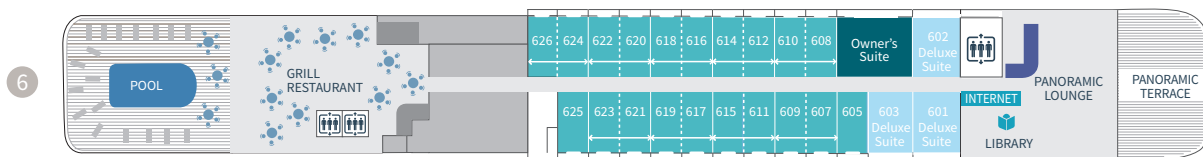
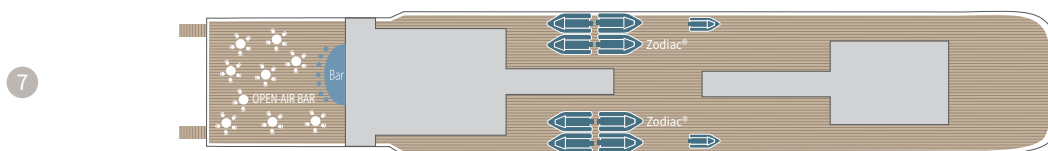

Le Lyrial

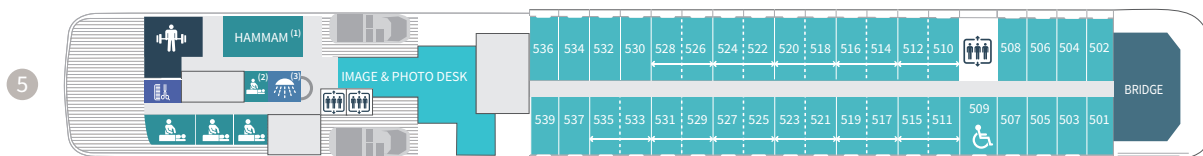

Configuration: L'Austral; <sup>(1)</sup> Locker <sup>(2)</sup> Hamman <sup>(3)</sup> Locker • Le Boréal; <sup>(1)</sup> Massage <sup>(2)</sup> Hamman <sup>(3)</sup> Locker • Le Soléal; <sup>(1)</sup> Hamman <sup>(2)</sup> Locker <sup>(3)</sup> Locker.

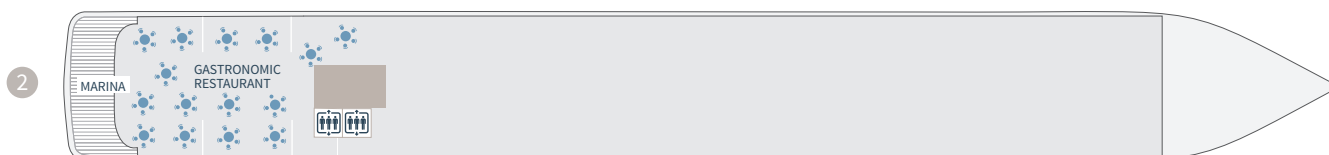
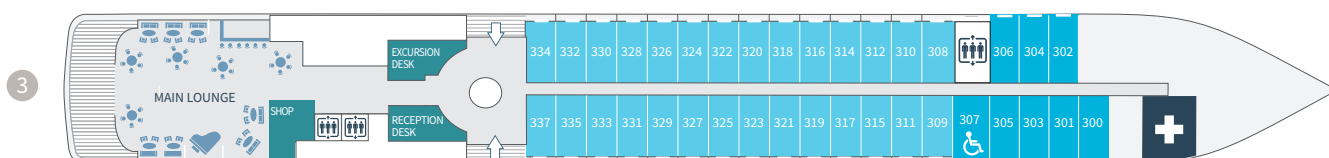
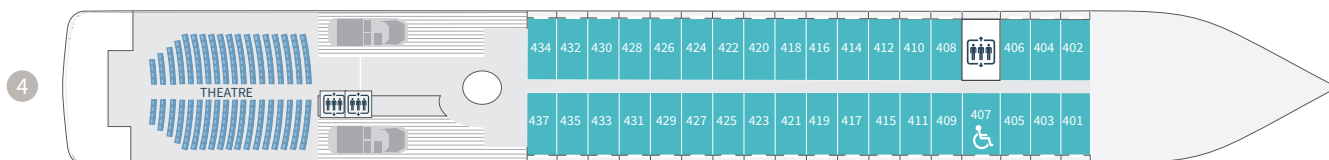

Scan here for  
immediate  
embarkation  
on board our  
Sisterships.



- Owner's Suite  
Deck 6
- Grand Privilege Suite  
Deck 6 (Le Lyrial)
- Privilege Suites  
Deck 6 (Le Lyrial)

- Prestige Suites  
Deck 5 - 6 (except Le Lyrial)
- Grand Deluxe Suite  
Deck 6 (Le Lyrial)
- Deluxe Suites  
Deck 6

- Prestige Staterooms  
Deck 4 - 5 - 6
- Deluxe Staterooms  
Deck 3
- Superior Staterooms  
Deck 3



# Discover your Stateroom

## OWNER'S SUITE aboard *Le Lyrial*

(55 sq.m/581 sq.ft + 12 sq.m/129 sq.ft private balcony with sliding bay windows)

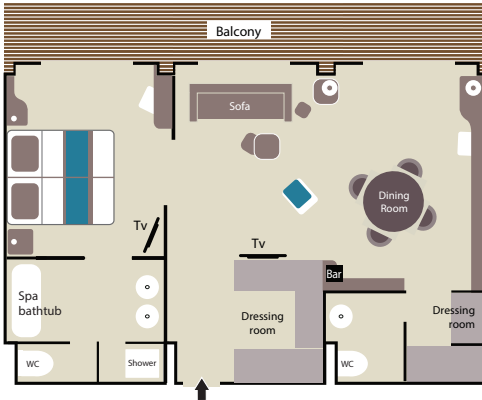

## GRAND PRIVILEGE SUITE aboard *Le Lyrial*

(55 sq.m/581 sq.ft + 12 sq.m/129 sq.ft private balcony with sliding bay windows)

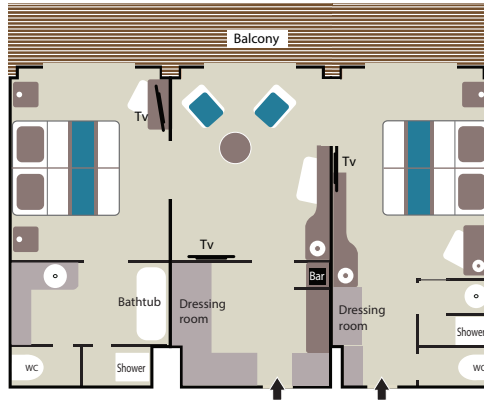

## PRIVILEGE SUITE aboard *Le Lyrial*

(37 sq.m/388 sq.ft + 8 sq.m/86 sq.ft private balcony with sliding bay windows)

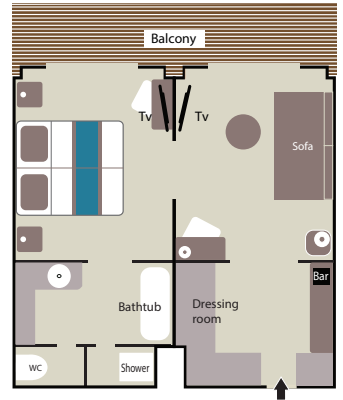

## OWNER'S SUITE

(45 sq.m/484 sq.ft + 9 sq.m/97 sq.ft private balcony with sliding bay windows)

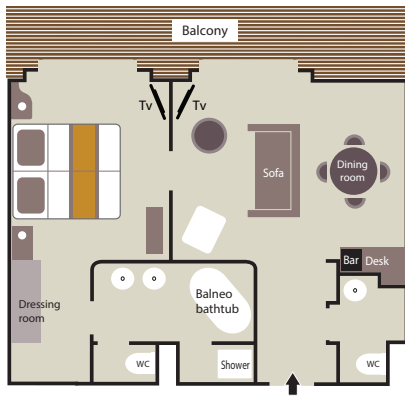

## GRAND DELUXE SUITE aboard *Le Lyrial*

(45 sq.m/484 sq.ft + 10 sq.m/108 sq.ft private balcony with sliding bay windows)

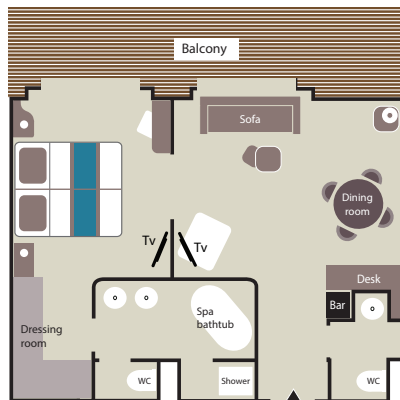

## PRESTIGE SUITE

(37 sq.m/398 sq.ft + 8 sq.m/86 sq.ft private balcony with sliding bay windows)

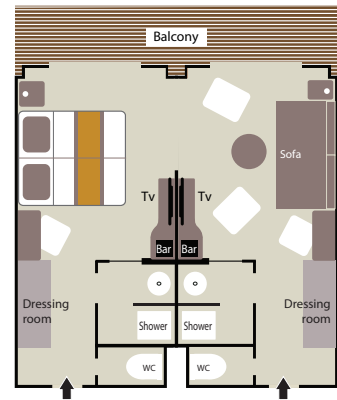

Prestige Suites aboard *Le Boréal* & *Le Soléal*: 1 shower and 1 bathtub.

## DELUXE SUITE

(27 sq.m/290 sq.ft + 6 sq.m/64 sq.ft private balcony with sliding bay window)

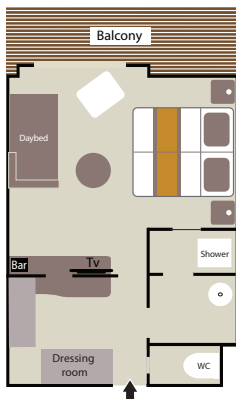

Deluxe Suites aboard *Le Boréal*: 1 shower and 1 bathtub

## PRESTIGE STATEROOM

(18.5 sq.m/200 sq.ft + 4 sq.m/43 sq.ft private balcony with sliding bay window)

Deck 4

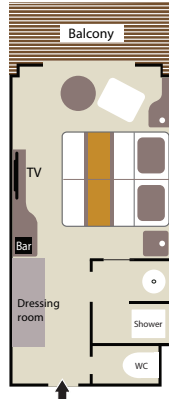

Deck 5-6

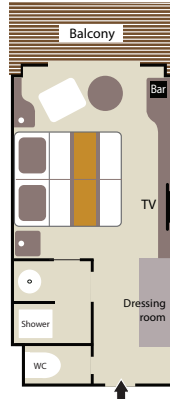

Prestige Staterooms aboard *Le Boréal* & *Le Soléal*, decks 5 & 6: 1 shower or bathtub depends on cabins

## DELUXE STATEROOM

(18 sq.m/200 sq.ft + 4 sq.m/43 sq.ft private balcony with French window)

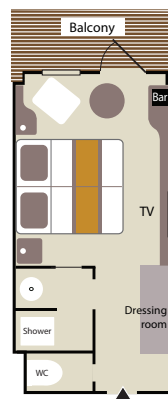

## SUPERIOR STATEROOM

(21 sq.m/226 sq.ft)

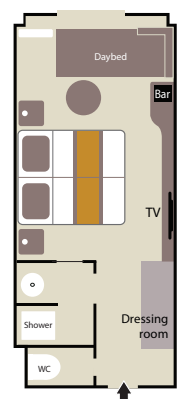



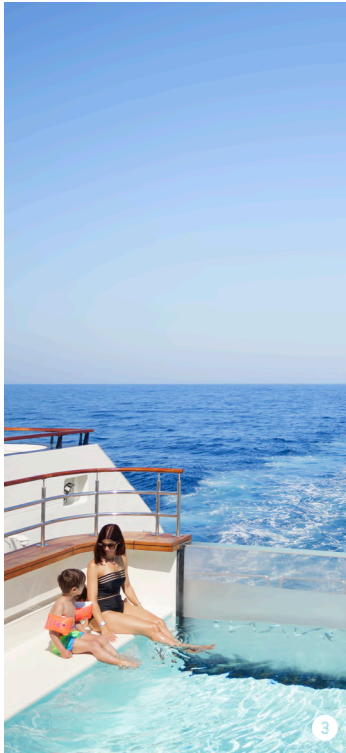

## The PONANT Explorers

Equipped with only 92 staterooms, a multi-sensory underwater lounge, the *Blue Eye*, and the latest technologies to limit the impact on the environment, *Le Lapérouse*, *Le Champlain*, *Le Bougainville*, *Le Dumont-d'Urville*, *Le Bellot* and *Le Jacques-Cartier* enable you to make stopovers in remote regions.







1. The Blue Eye, multi-sensory underwater lounge
2. The Spa, in partnership with Sothys or Clarins
3. The pool deck and its solarium
4. The panoramic restaurant, open to the outside
5. The theatre, where conferences, shows and performances take place

6. *Le Bougainville*
7. The Owner's Suite
8. The Owner's Suite, its private terrace and hot tub
9. Prestige Suite living room, *Le Lapérouse*

## Amenities

- Individually controlled airconditioning
- Stateroom layout: king-size bed, or twin beds, communicating Staterooms available (children welcome)
- Minibar
- Flat-screen satellite TV
- Video on demand
- Bose Bluetooth speaker
- Safe

- Diptyque bath products
- Dressing table, bath robes, hairdryer
- Direct line telephone
- 110V American (two flat pins)/220V European (round sockets with two round pins)
- 24hr room service
- Inclusive Wifi internet access\*

*\*Depending on the navigation areas, the Wifi may not be accessible for reasons beyond our control.*



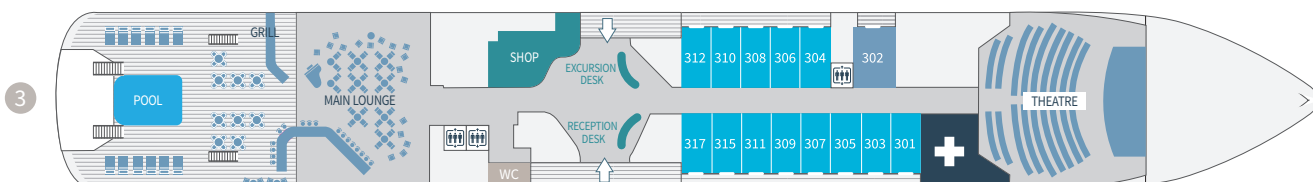
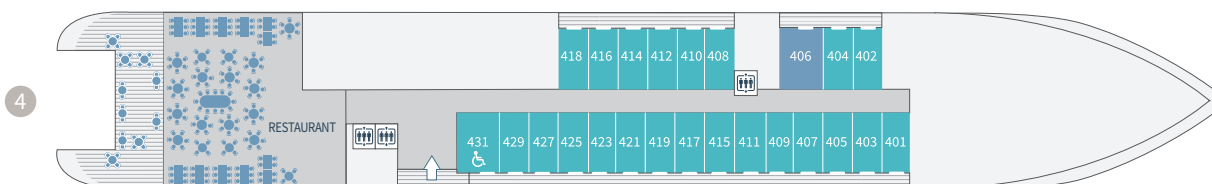
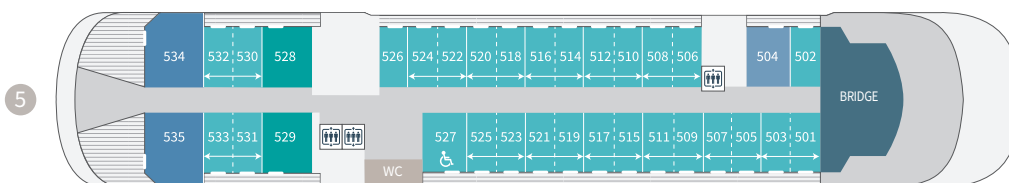
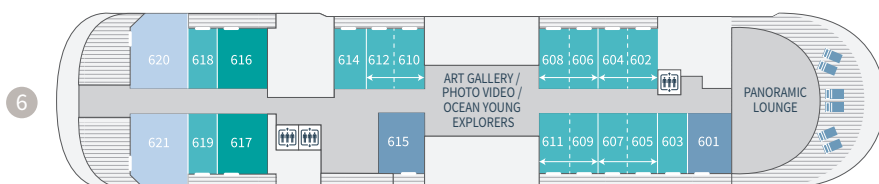
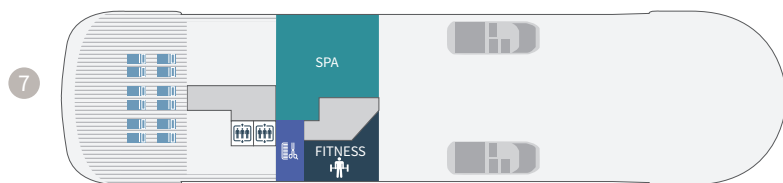

- |                                |                               |                                       |                             |
|--------------------------------|-------------------------------|---------------------------------------|-----------------------------|
| Owner's Suites<br>Deck 5       | Grand Deluxe Suites<br>Deck 6 | Deluxe Suites<br>Deck 3 - 4 - 5 - 6   | Deluxe Staterooms<br>Deck 3 |
| Privilege Suites<br>Deck 5 - 6 | Prestige Suites<br>Deck 5 - 6 | Prestige Staterooms<br>Deck 4 - 5 - 6 |                             |

# Discover your Stateroom

## OWNER'S SUITE

(45 sq.m/484 sq.ft + 40 sq.m/430 sq.ft private terrace with hot tub and sliding bay windows)



## GRAND DELUXE SUITE

(45 sq.m/484 sq.ft + 30 sq.m/323 sq.ft private terrace with sliding bay windows)

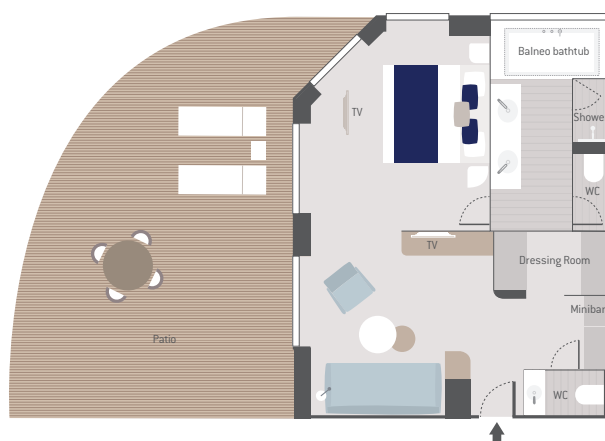

## PRIVILEGE SUITE

(32 sq.m/344 sq.ft + 8 sq.m/86 sq.ft private balcony with sliding bay window)

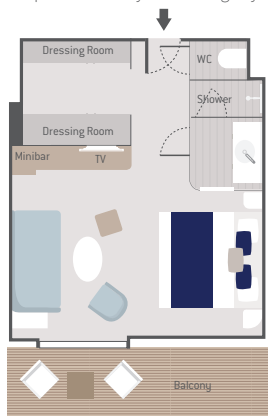

## PRESTIGE SUITE

(38 sq.m/409 sq.ft + 8 sq.m/86 sq.ft private balcony with sliding bay window)

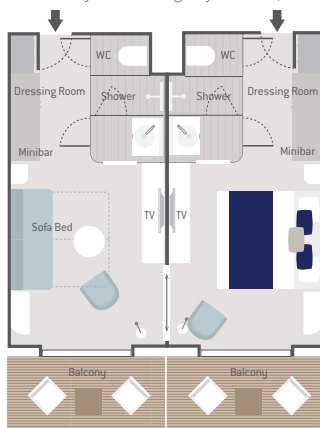

## PRESTIGE STATEROOM

(19 sq.m/204 sq.ft + 4 sq.m/43 sq.ft private balcony with sliding bay window)



## DELUXE SUITE

(27.5 sq.m/291 sq.ft + 6 sq.m/65 sq.ft private balcony with sliding bay window)

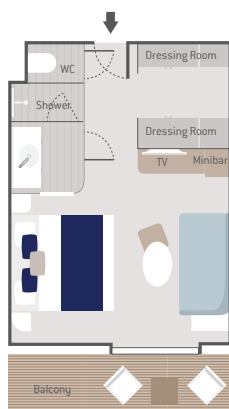

## DELUXE STATEROOM

(19 sq.m/204 sq.ft + 4 sq.m/43 sq.ft private balcony with French window)

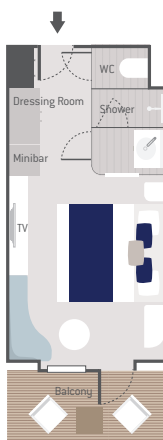

Scan here for immediate  
embarkation on board  
the PONANT Explorers.

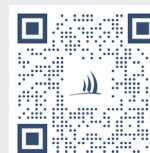





Contact Cruise World on 09 917 4440 | 0800 500 732  
info@cruiseworld.co.nz | www.cruiseworld.co.nz

RELEASE DATE: APRIL 2023

